

Blower

Replacement (cont'd)

6. (With A/C)
Remove the A/C bands (2) and remove the blower under cover.
NOTE: Be careful not to break the tabs while removing the blower under cover.
Remove the blower as in step 4.

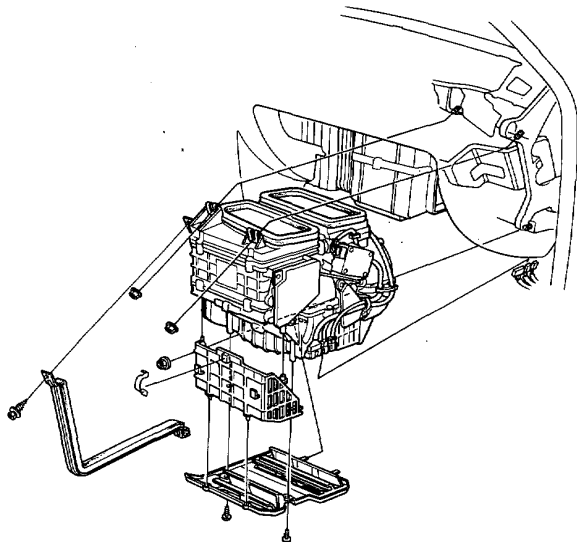

7. Install the blower in the reverse order of removal and make sure there is no air leakage.
NOTE: When installing the glove box frame, the face which covers the dashboard is installed with double-sided adhesive tape.

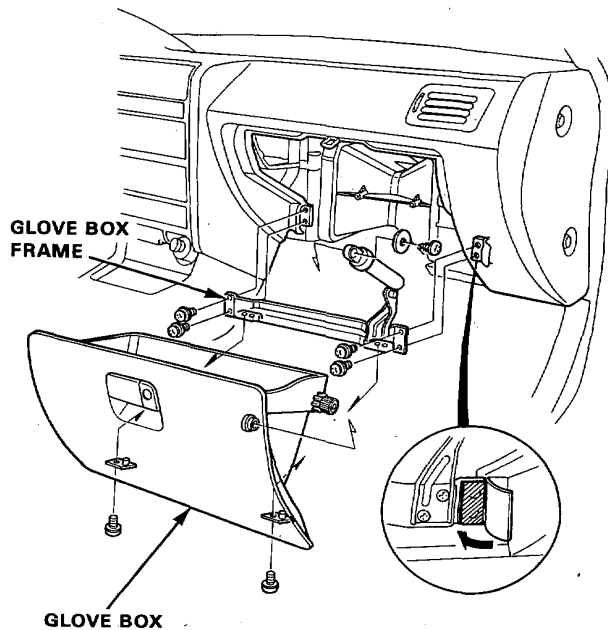



Overhaul

NOTE:

- Before reassembly, make sure that the air door and linkage moves smoothly without binding.
- When reattaching the actuator, make sure its positioning will not allow the air door to be pulled too far. Attach the actuator and all linkage, then apply battery voltage and watch the door movement. If necessary, loosen the holding screw and move the actuator up or down.

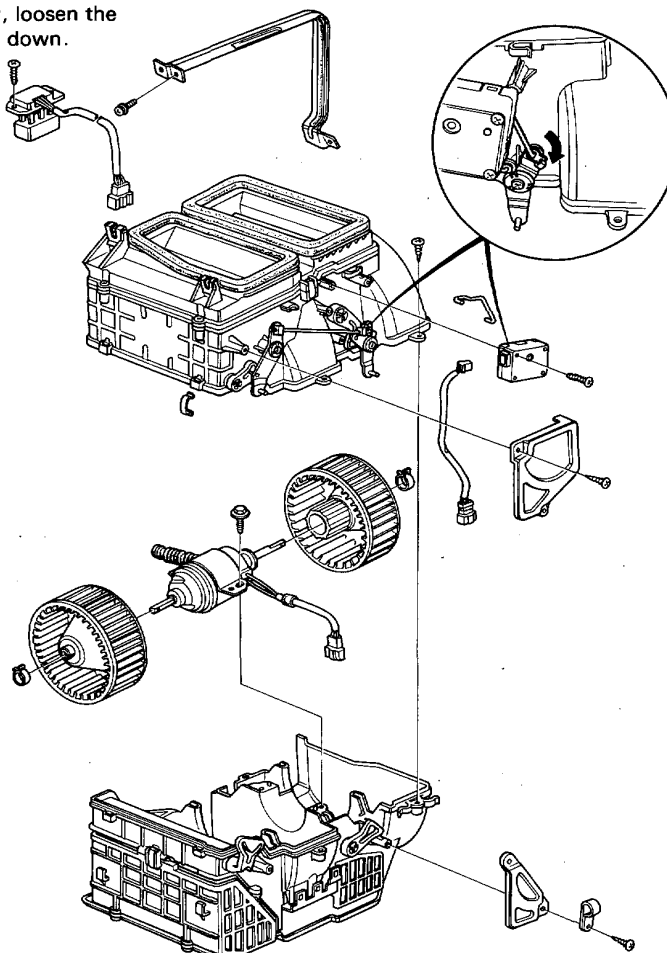

To adjust the control rod:

Connect the recirc. control motor connector to the cabin wire harness and turn the FRE/REC switch to "REC". Hold the air door closed, then connect the control rod to the clip on the arm.

